

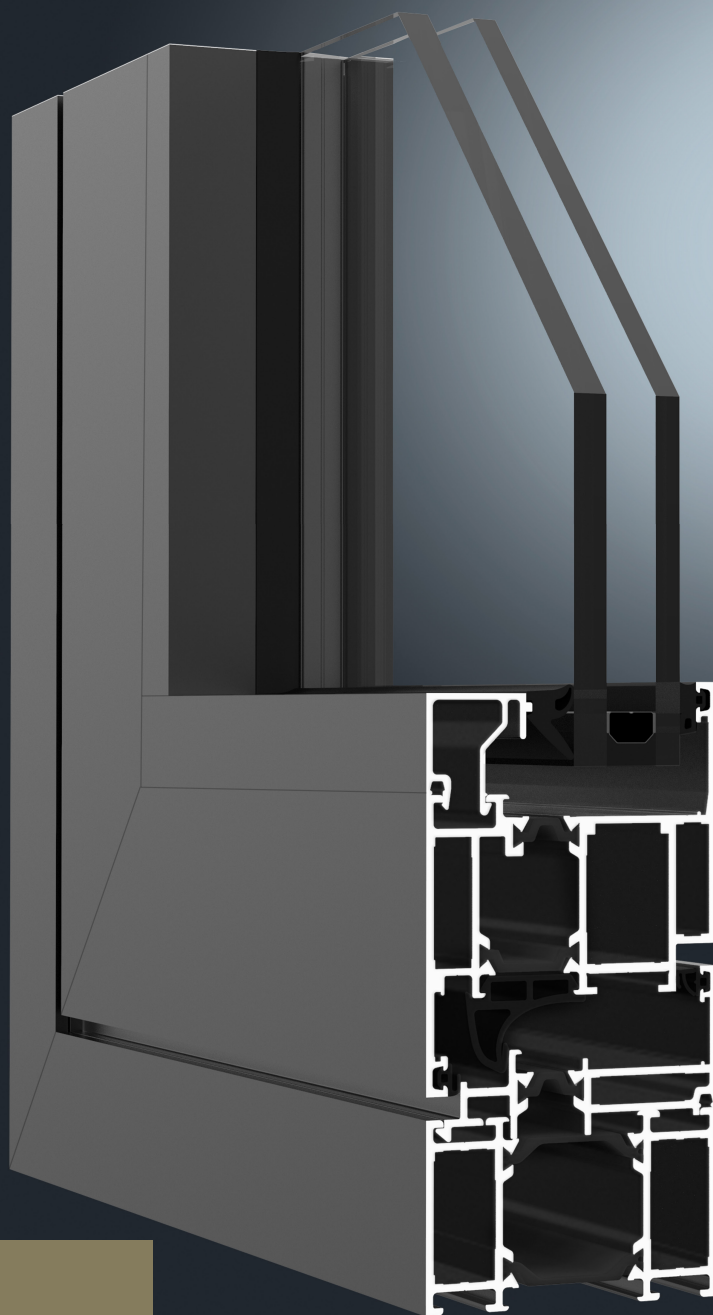

GUTMANN S70+

Awning Window System



GUTMANN
New dimensions
offer new
perspectives

ALUMINUM SHAPED BY GUTMANN



GUTMANN S70+ AWNING SYSTEM

Innovative technology at its peak, with greater design and constructive flexibility

The GUTMANN S70+ Awning System is a thermally insulated aluminum window system and has been designed and engineered to provide the highest level of quality.

The profile section depth for both the frame and leaf is 70mm = 2 3/4" and is thermally broken. These windows may be installed as independent units or adapted to fit into most of the storefronts, window walls, or curtain wall systems.

SYSTEM DESCRIPTION

- › AW95 Performance Class
- › Profiles with a three-chamber system in symmetrical structure and identical inner & outer glass bead grooves
- › Symmetrical, stable structural design with identical corner and T-connectors
- › Thermally and structurally optimized winglet insulator with high-strength polyamide thermal barrier
- › Available in wide range of profile depths
- › Glass up to 2" (50mm) in the fixed panel
- › Life Cycle Tested to AAMA 910 and NAFS

Our in-house design assistance, engineering, and manufacturing ensure maximum efficiency throughout the entire process.

SYSTEM PROPERTIES

Size Limitation: 59 2/16" x 52 3/4" (1502 mm x 1340 mm)



Canadian Air infiltration /Exfiltration
ASTM E283
A3 Level



Water Penetration
ASTM E547-00
720 Pa (15.04 PSF) - No leakage - Prior to, After Cycling and After Design Load



Uniform Load Structural Test Pressure
ASTM E330-14
+/-6840 Pa (+/- 142.86 PSF)



Design Pressure
ASTM E330-14
+/-4560 Pa (+/- 95.24 PSF)



Forced Entry Resistance
AAMA F588-14
Grade 10 Pass



Operating Force
ASTM E2068
<22N (<5lbf)



Air Leakage
ASTM E283-04
0.01 cfm/ft2 - Prior to the cycles
0.01 cfm/ft2 - After cycling
0.02 cfm/ft2 - After Design Load
0.10 cfm/ft2 - Allowed @ 6.27 PSF



Thermal Transmittance (U-Factor)
NFRC 100
Shall not exceed 0.43Btu/hr/ft2-F° for double glazed and 0.37 Btu/hr/ft2-F° with triple glazed. This value may vary according to glass selection and framing configuration.

SYSTEM CROSS-SECTION

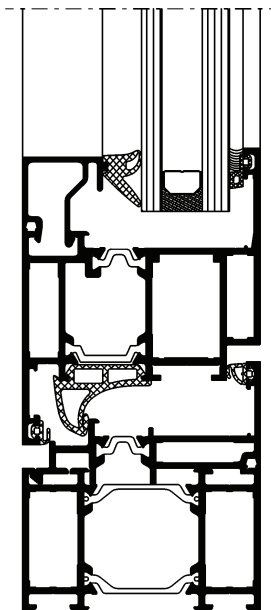

Double Glass Unit

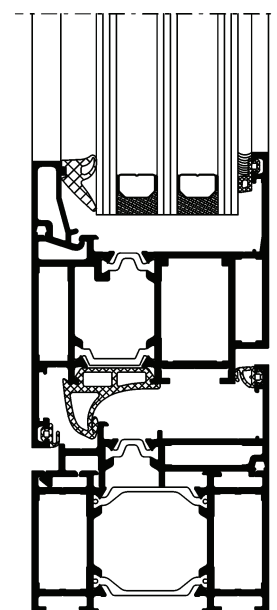

Triple Glass Unit



GUTMANN
Innovative
technology
at the
highest level

**BECOME A GUTMANN PARTNER AND
ENJOY THE FOLLOWING ADVANTAGES:**

- › Many years of experience and expertise in façade business
- › We offer you everything from a single source: structural engineering advice in design and planning phase of a building, as well as support in the implementation of existing system technology with special system-based solutions
- › Top quality products are our trademark and basis of our reputation
- › High storage capacity and efficient logistics ensure fast and punctual delivery
- › Maximum customer benefit characterized by a successful combination of sophisticated design, certified safety, and sustainable profitability



GUTMANN NORTH AMERICA
Suite 200, 2020 Winston Park Dr
Oakville, ON, L6H 6X7, Canada
T: (416) 488 6266

www.gutmann-na.com