

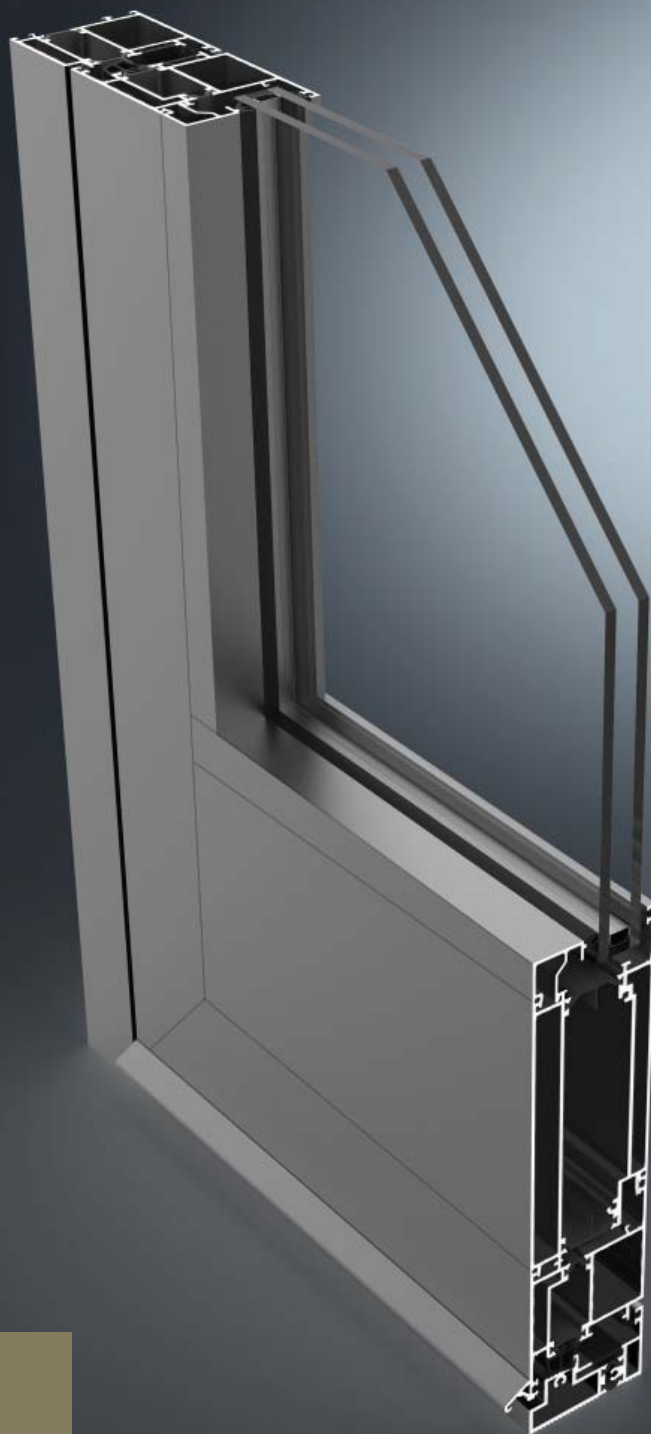

GUTMANN S70+

Outswing Door 25mm Threshold



GUTMANN
New dimensions
offer new
perspectives

ALUMINUM SHAPED BY GUTMANN



GUTMANN S70+ OUTSWING DOOR 25mm

Innovative technology at its peak, with greater design and constructive flexibility

The GUTMANN S70+ Outswing architectural doors are ideal for mid-rise residential projects, condominiums, and hotels with the additional benefit of polyamide thermal barriers for enhanced thermal performance.

This door system meets elevated requirements regarding thermal insulation, stability, and security. It can be installed as a stand-alone product or easily integrated into GUTMANN's systems.

SYSTEM DESCRIPTION

- › NAFS AW90 Performance Class
- › Ideal for residential and commercial applications
- › Outstanding craftsmanship, strength, and durability
- › The top rail is 3" (75mm) height and the bottom rail 3" (75mm) with a threshold of 1" (25mm)
- › Profiles have three-chamber systems with the frame depth is 2 3/4" (70mm)
- › Out-swing operation with an option of single and double leaf door
- › Sturdy corner-blocked and crimped door leaf construction; tested indoor leaf sizes up to 43" (1092mm) x 93 1/4" (2369mm)
- › Accommodates 1" (25.4mm) to 1 7/8" (48 mm) double glazed sealed units
- › Optional surface mounted door closers
- › Optional installation of mortise locks and striking plates with slide blocks
- › Dry glazed, using compression gaskets, and innovative seals
- › Hardware with multipoint locking
- › Finishes available in a variety of standard and custom colours
- › Easily integrates with other GUTMANN products
- › Life Cycle Tested to AAMA 910 and NAFS

SYSTEM PROPERTIES

Specimen Size: 47 5/16" x 96" (1203mm x 2438mm)

Leaf Size: 43" x 92 10/16" (1092mm x 2353mm)



Air Leakage Infiltration / Exfiltration
ASTM E283

0.01 cfm/ft² -prior to the cycles
and after cycling
0.02 cfm/ft² -after design load
0.10 cfm/ft² (allowed) @ 6.27 psf



Water Penetration
ASTM E547-00 & ASTM E331-00

720 pa (15.04 psf)- No leakage-prior to, after
cycling and after design load



Canadian Air Leakage
ASTM E283
A3 Level



Design Pressure
ASTM E330-14
+/-4320 Pa (+/- 90.23 psf)



Uniform Load Structural Test Pressure
ASTM E330-14
+/-6480 Pa (+/- 135.34 psf)



Operating Force
ASTM E2068-00
≤27N (≤6lbf)



Forced Entry Resistance
AAMA 1304-02
300 lb (136 Kg)



Thermal Transmittance (U-Factor)
Shall not exceed 0.38 Btu/hr/ft²-F° for double
glazed and 0.32 Btu/hr/ft²-F° with triple glazed.
This value may vary according to glass selection
and framing configuration.

SYSTEM CROSS-SECTION

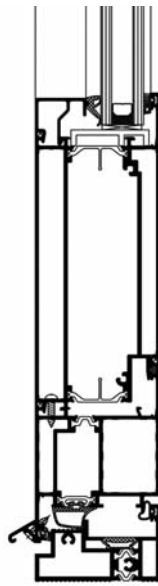

Double Glazed

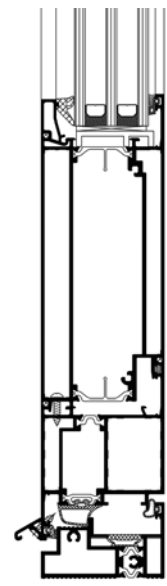

Triple Glazed



KÜHNE+NAGEL

GUTMANN
Innovative
technology
at the
highest level

**BECOME A GUTMANN PARTNER AND
ENJOY THE FOLLOWING ADVANTAGES:**

Industry Expertise: With extensive experience, we stand as a leader in the façade business, showcasing deep industry knowledge and understanding.

Comprehensive Solutions: From structural engineering consulting to implementing advanced system technology, we tailor end-to-end solutions for your unique project requirements.

Quality Commitment: Our reputation in the aluminum industry is built on a steadfast commitment to delivering top-quality products.

Efficient Logistics: Backed by high storage capacity and streamlined logistics, we guarantee swift and punctual deliveries, enhancing overall project efficiency.

Customer-Centric Approach: Success is achieved through the seamless integration of sophisticated design, certified safety, and sustainable profitability, ensuring maximum customer satisfaction.



GUTMANN NORTH AMERICA
418 Iroquois Shore Rd | Suite 203,
L6H 0X7, Oakville, ON, Canada
T: + 1 (416) 488 6266

www.gutmann-na.com