

S70+ Windows

Available in Multiple Configurations

SYSTEM DESCRIPTION

› The Gutmann S70+ Window System is a high performance window engineered with a three-chamber profile and a high-strength polyamide thermal barrier, ensuring superior energy efficiency and structural performance. Designed for versatility, it features a Euro groove for flexible hardware selection and supports concealed fittings up to 400 lbs (180 kg). The system accommodates glass thicknesses of up to 2 3⁄8” (60 mm) in the sash and 2” (50 mm) in the fixed panel.

› With a frame depth of 2 3⁄4” (70 mm), while the sash depth is 3 1⁄8” (80 mm). The S70+ Window is designed to be symmetrical with identical corners and T connectors.

› Windows may be installed as independent units in punched openings, or adapted to fit into most storefront, window wall, or curtain wall systems.

SYSTEM PROPERTIES



ASTM E283
infiltration
◀0.01 cfm/ft²
exfiltration
0.01 cfm/ft²
@ 6.27 PSF



ASTM E283
A3 Level



ASTM E547
15.04 PSF
(720 Pa)
no leakage
tested with and
without insect
screen



ASTM F588
Grade 10 Pass



ASTM E330
+/- 95.24 PSF
(+/- 4560 Pa)



ASTM E330
+/- 142.86 PSF
(+/- 6840 Pa)



ASTM E2068
◀5 lbf (22N)



NFRC 100
0.21 Btu/hr/ft²-Fº
with double glazed
and 0.11 Btu/hr/ft²-Fº
with triple glazed.

CROSS SECTION

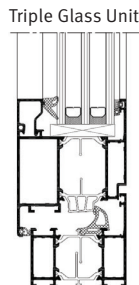
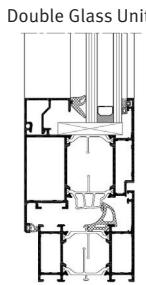

Project Out Top-Hung/Awning

- › AW-PG95 Performance Class
- › Life Cycle Tested to AAMA-910
- › Glass thickness up to 2 3⁄8” (60 mm)

Fixed Window

- › AW-PG90 Performance Class
- › Tested to NAFS
- › Glass thickness up to 2” (50 mm)

ASTM E283
infiltration
◀0.01 cfm/ft²
exfiltration
◀0.01 cfm/ft²
@ 6.27 PSF

ASTM E283
Fixed Level

ASTM E547
15.04 PSF
(720 Pa)
no leakage

ASTM F588
Grade 10 Pass

ASTM E330
+/- 90.23 PSF
(+/- 4320 Pa)

ASTM E330
+/- 135.34 PSF
(+/- 6480 Pa)

NFRC 100
0.26 Btu/hr/ft²-Fº
with double glazed
and 0.17 Btu/hr/ft²-Fº
with triple glazed.

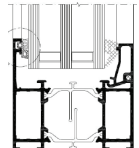
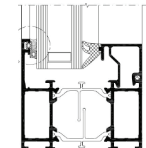

Inswing Casement

- › AW-PG80 Performance Class
- › Life Cycle Tested to AAMA 910
- › Glass thickness up to 2 3⁄8” (60 mm)

ASTM E283
infiltration
◀0.06 cfm/ft²
exfiltration
◀0.08 cfm/ft²
@ 6.27 PSF

ASTM E283
A3 Level

ASTM E547
15.04 PSF
(720 Pa)
no leakage

ASTM F588
Grade 40 Pass

ASTM E330
+/- 80.20 PSF
(+/- 3840 Pa)

ASTM E330
+/- 120.30 PSF
(+/- 5760 Pa)

ASTM E2068
◀4.68 lbf (20N)

NFRC 100
0.21 Btu/hr/ft²-Fº
with double glazed
and 0.11 Btu/hr/ft²-Fº
with triple glazed.

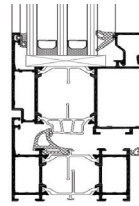
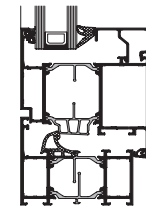

Zero Sightline Vent System

- › AW-PG65 Performance Class
- › Life Cycle Tested to AAMA 910
- › Glass thickness up to 1 3⁄4” (44 mm)

ASTM E283
infiltration
◀0.02 cfm/ft²
exfiltration
◀0.03 cfm/ft²
@ 6.27 PSF

ASTM E283
A3 Level

ASTM E547
15.04 PSF
(720 Pa)
no leakage

ASTM F588
Grade 20 Pass

ASTM E330
+/- 65.16 PSF
(+/- 3120 Pa)

ASTM E330
+/- 97.74 PSF
(+/- 4680 Pa)

ASTM E2068
◀5 lbf (22.5N)

NFRC 100
0.15 Btu/hr/ft²-Fº
using COG 0.098

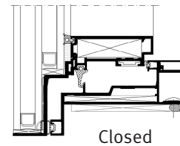
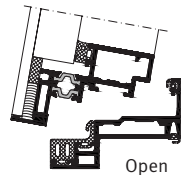

Vent variants available with 4” limiter for ADA code compliance.

Note that **Thermal Transmittance (U-Factor)** value may vary according to glass selection and framing configuration.



ALUMINUM SHAPED BY GUTMANN

Nearly a century of cutting-edge technology, offering enhanced flexibility in design and construction.

Our Services

We provide comprehensive in-house support for aluminum system design, engineering, and manufacturing.

From structural and thermal calculations to custom extrusions and project-specific solutions, we ensure precision at every stage.

Our services include fabrication drawings, mock-up construction and testing, material estimates, and expert consulting backed by dedicated after-sales support for seamless project execution.



GUTMANN S Series

S70+ Windows & S70SK Zero Sightline Vent

The GUTMANN S70+ Window System delivers exceptional energy efficiency, durability, and sleek aesthetics for commercial and residential projects. Precision-engineered for high performance, it offers a range of configurations designed to enhance ventilation and allow for easy maintenance such as: **Outswing & Inswing casement, Fixed Window, Dual-Action Tilt/Turn, Pop-out, Top-Hung Project-Out/Awning, and can be customized to fit any design specification.**

With a **2 3/4" (70 mm) profile depth**, it accommodates double and triple insulating glass increasing thermal performance. The S70+ sets a new standard in window system versatility and performance, seamlessly integrating into diverse applications

The S70SK Zero Sightline Vent Enhances building comfort while maintaining sleek facades. This AW-rated system integrates with curtain walls and supports vent sizes up to 60 x 90" (1530 x 2300 mm), with glass thicknesses up to 1 3/4" (44 mm).

Upgrade to Gutmann windows for innovation, efficiency, and lasting performance.



GUTMANN NORTH AMERICA
Oakville, ON, Canada
T: + 1 (416) 488 6266
E: info@gutmann-na.com
gutmann-na.com

