



KF 1000 - GLASS RAILING SYSTEMS

KF 1000 series, which is the upper mounting model designed and developed by Gutmann Railing, brings under the spotlight the simplicity and transparency of the glass, and it has been designed in a way to meet all kinds of needs and expectations with its reliability and convenience.

The **Glassmove®** mechanism, which provides flexibility for the glass is available in the KF 1000 series. The KF 1000 series was developed and structured in line with the recommendation and demands of architectures in the application field, and it may be used in larger projects such as shopping malls and hotels.

Thickness of the glass may be selected optionally between 12 -21.52 millimeters.

KF 1000 CODES



PROFILE DRAWINGS

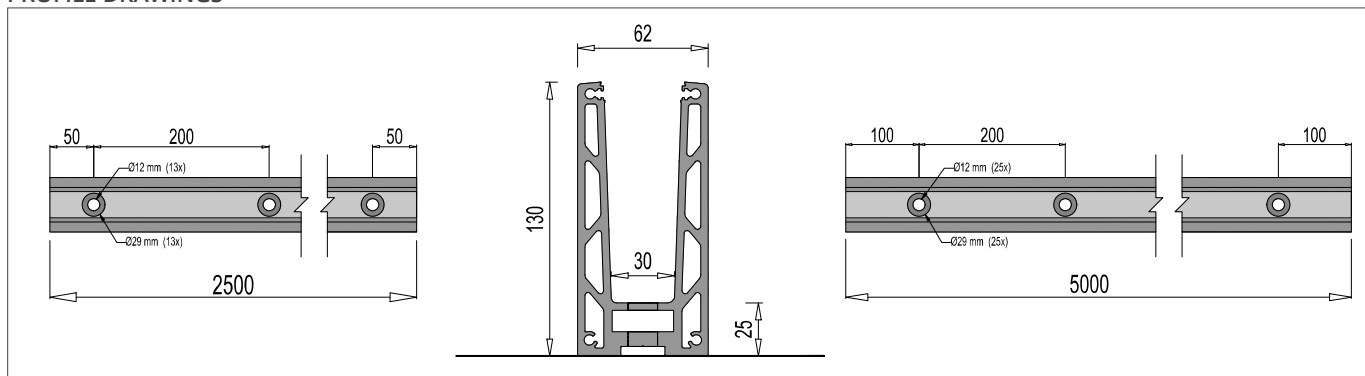



Glassmove® INFO

ADVANTAGES

- **Glassmove®** parts can be use
- Usable glass thickness should be between 12 - 21.52 mm
- Slimline and elegant design.
- Quick installation with ready holes.
- Extension pin holes.
- Internal drainage holes for rain.
- Limitless transparency view.
- Anodized - ral - satine colour choose.

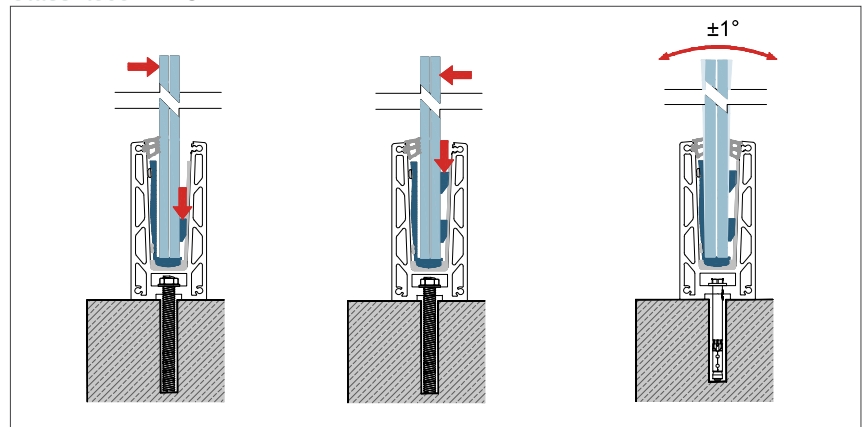

DRAINAGE DETAILS

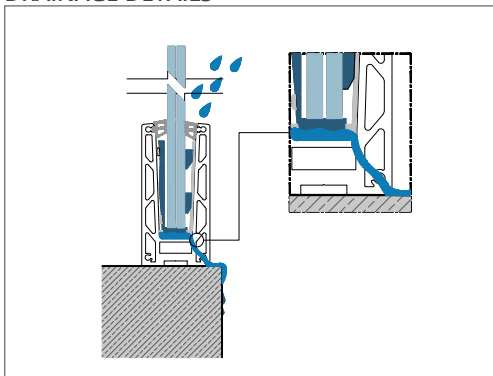

ANCHORING POSSIBILITY FOR THE KF - 1000

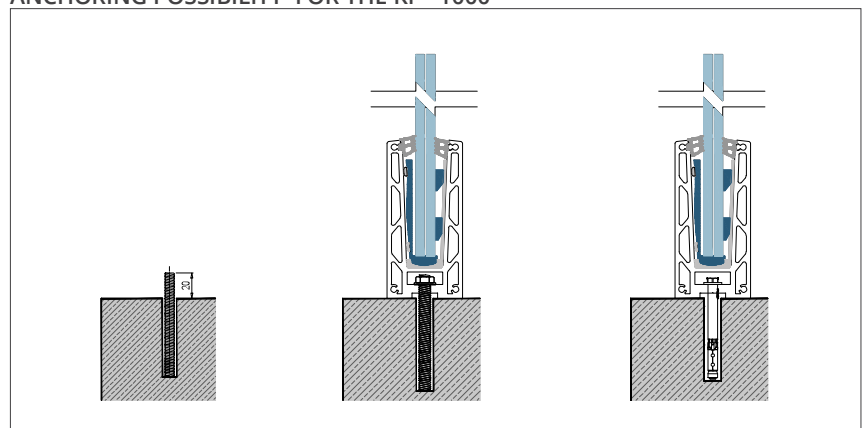

INSTALLATION PART I

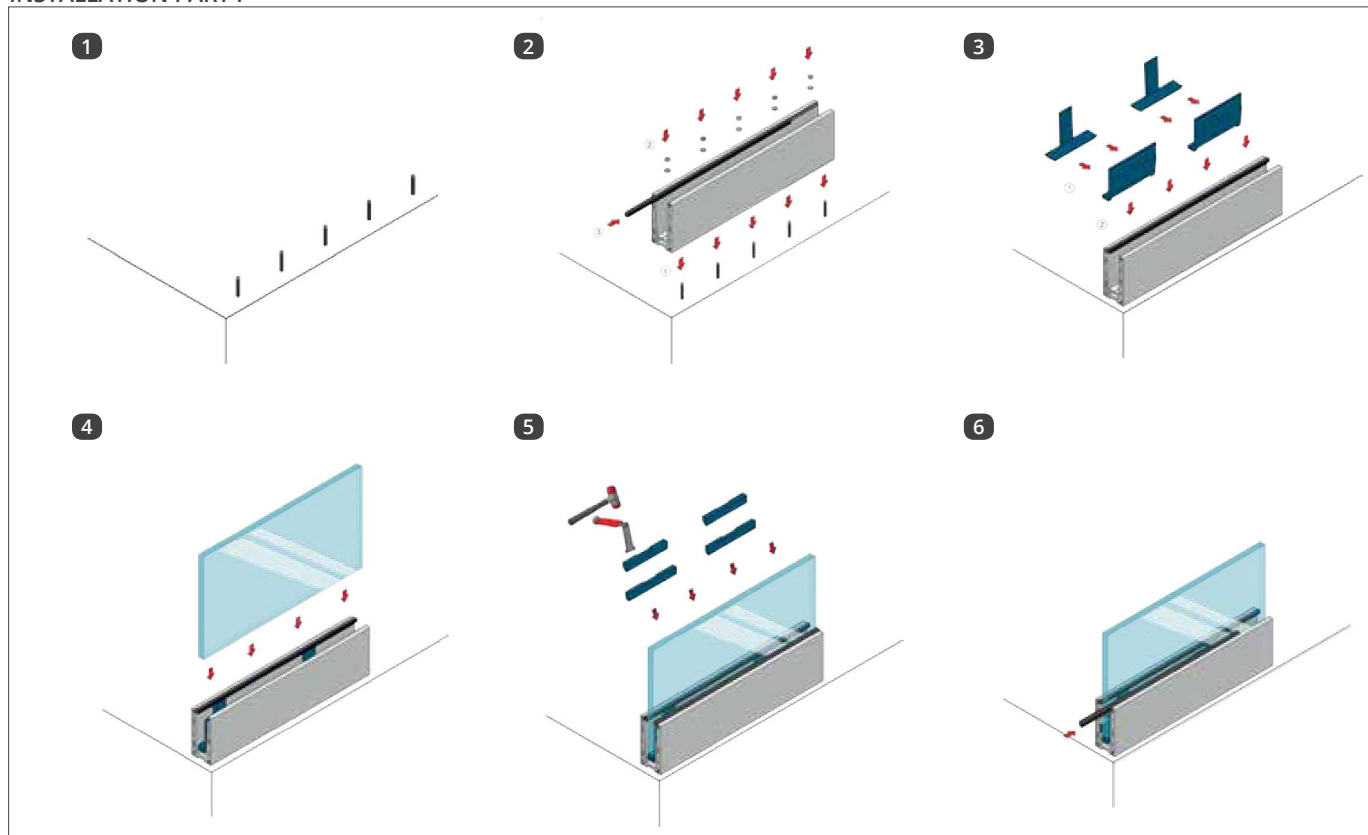

INSTALLATION PART II

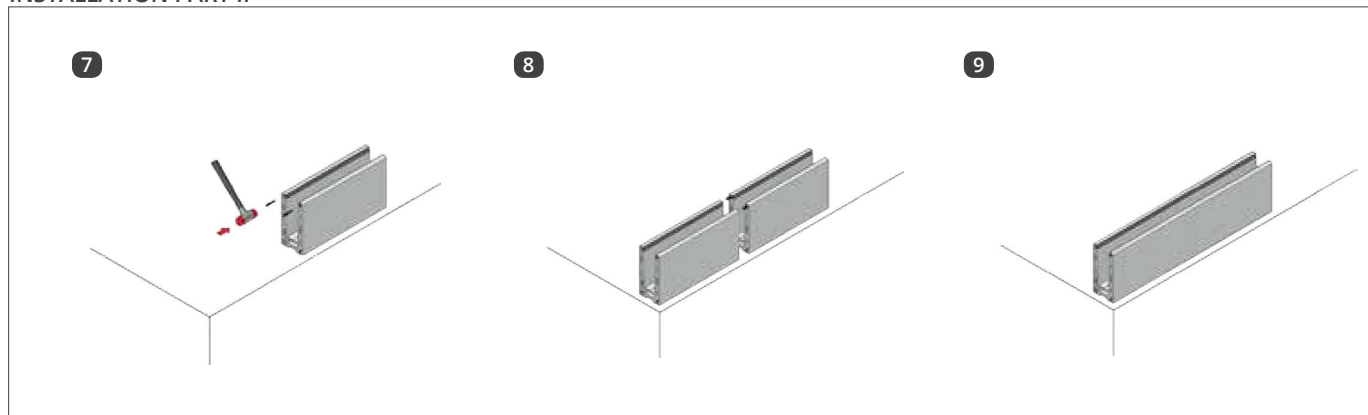

INSTALLATION PART III

