

S70+ Windows

Available in Multiple Configurations

SYSTEM DESCRIPTION

The Gutmann S70+ Window System is a high performance window engineered with a three-chamber profile and a high-strength polyamide thermal break, ensuring superior energy efficiency and structural performance. Designed for versatility, the S70+ supports concealed hardware weighing up to 400 lbs (180 kg).

› Accommodates glass thicknesses of up to 2 3⁄8” (60 mm) in the sash and 2” (50 mm) in the fixed panel.

› With a frame depth of 2 3⁄4” (70 mm), while the sash depth is 3 1⁄8” (80 mm). The S70+ Window is designed to be symmetrical with identical corners and T connectors.

› Windows may be installed as independent units in punched openings, or adapted to fit into most storefront, window wall, or curtain wall systems.



SYSTEM PROPERTIES



Air Leakage
Infiltration/
Exfiltration



Canadian Air Leakage
Infiltration/
Exfiltration



Water Penetration



Forced Entry



Design Pressure



Uniform Load Structural Test Pressure



Operating Forces



Thermal Transmittance (U-Factor)

CROSS SECTION

Double Glass Unit

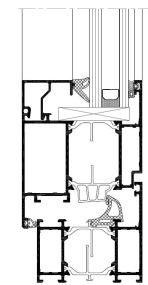

Triple Glass Unit

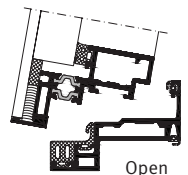
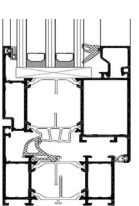
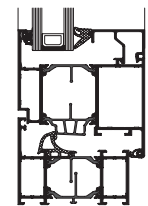
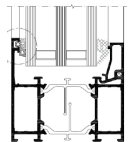
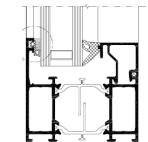
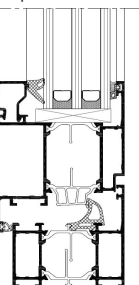

Open



Closed

Top-Hung/Awning/Project Out

- › AW-PG95 Performance Class
- › Life Cycle Tested to AAMA-910
- › Glass thickness up to 2 3⁄8” (60 mm)

ASTM E283

infiltration
<0.01 cfm/ft²
exfiltration
0.01 cfm/ft²
@ 6.27 PSF

ASTM E283

A3 Level

ASTM E547

15.04 PSF
(720 Pa)
no leakage
tested with and without insect screen

ASTM F588

Grade 10 Pass

ASTM E330

+/- 95.24 PSF
(+/- 4560 Pa)

ASTM E330

+/- 142.86 PSF
(+/- 6840 Pa)

ASTM E2068

<5 lbf (22N)

NFRC 100

0.21 Btu/hr/ft²-Fº
with double glazed
and 0.11 Btu/hr/ft²-Fº
with triple glazed.

Fixed Window

- › AW-PG90 Performance Class
- › Tested to NAFS
- › Glass thickness up to 2” (50 mm)

ASTM E283

infiltration
<0.01 cfm/ft²
exfiltration
<0.01 cfm/ft²
@ 6.27 PSF

ASTM E283

Fixed Level

ASTM E547

15.04 PSF
(720 Pa)
no leakage

ASTM F588

Grade 10 Pass

ASTM E330

+/- 90.23 PSF
(+/- 4320 Pa)

ASTM E330

+/- 135.34 PSF
(+/- 6480 Pa)

NFRC 100

0.26 Btu/hr/ft²-Fº
with double glazed
and 0.17 Btu/hr/ft²-Fº
with triple glazed.

Inswing Casement/Open-in

- › AW-PG80 Performance Class
- › Life Cycle Tested to AAMA 910
- › Glass thickness up to 2 3⁄8” (60 mm)

ASTM E283

infiltration
<0.06 cfm/ft²
exfiltration
<0.08 cfm/ft²
@ 6.27 PSF

ASTM E283

A3 Level

ASTM E547

15.04 PSF
(720 Pa)
no leakage

ASTM F588

Grade 40 Pass

ASTM E330

+/- 80.20 PSF
(+/- 3840 Pa)

ASTM E330

+/- 120.30 PSF
(+/- 5760 Pa)

ASTM E2068

<4.68 lbf (20N)

NFRC 100

0.21 Btu/hr/ft²-Fº
with double glazed
and 0.11 Btu/hr/ft²-Fº
with triple glazed.

Zero Sightline Vent System

- › AW-PG65 Performance Class
- › Life Cycle Tested to AAMA 910
- › Glass thickness up to 1 3⁄4” (44 mm)
- › Typical size up to 60” x 90” (1530 x 2300 mm)

ASTM E283

infiltration
<0.02 cfm/ft²
exfiltration
<0.03 cfm/ft²
@ 6.27 PSF

ASTM E283

A3 Level

ASTM E547

15.04 PSF
(720 Pa)
no leakage

ASTM F588

Grade 20 Pass

ASTM E330

+/- 65.16 PSF
(+/- 3120 Pa)

ASTM E330

+/- 97.74 PSF
(+/- 4680 Pa)

ASTM E2068

<5 lbf (22.5N)

NFRC 100

0.15 Btu/hr/ft²-Fº
using COG 0.098

Vent variants available with 4” limiter for ADA and New York City Health Code [S. 131.15] compliance



Note that **Thermal Transmittance (U-Factor)** value may vary according to glass selection and framing configuration.